



# Eyeleds® Outdoor Pro



## Features & Benefits:

- A second generation of professional outdoor lighting, based on LED technology;
- Easy 'plug-and-play' installation by means of high quality M12 'Sensor connector' system;
- Widely applicable through a minimum in recess depth;
- Top quality SMD LED: bright and powerful light with an extreme long lifespan up to 100.000h;
- Solid 'walk/drive-over' construction, designed for loads up to 285kg;
- UV resistant, IP67 dust proof and water resistant;
- Low temperature, LED unit remains <35°C;
- Installation possible in accordance with official standards;
- 3 years of European Product Warranty.

## Materials & Dimensions:

- A: Light Surface: Polycarbonate lens 850°C - Ø 21,5mm.  
 B: Decoration Ring: Brushed Stainless Steel (1.4404/Inox 316) - Ø 37,4mm.  
 C: Trim Ring: Brushed Stainless Steel (1.4404/Inox 316) - Ø 45mm.

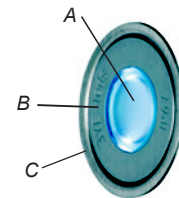

## System Components:

① Light Unit

Versions:  
 Brushed stainless steel finish / white LED  
 Brushed stainless steel finish / blue LED  
 Brushed stainless steel finish / amber LED  
 Brushed brass finish / amber LED  
 Brushed brass finish / white LED

② Power Supply

MAX. 40 LED

Available in EUR / UK / CH / US plug version

Connection Cables (T-splitter)

④ 30/30cm

③ 30/150cm

Extension cables

⑤ 200cm  
 ⑥ 500cm

## Connection & Build-In Diagram:

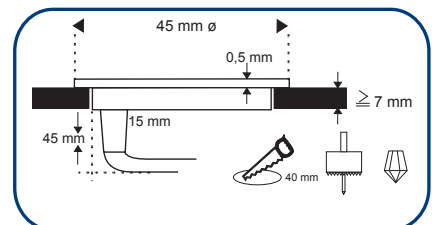
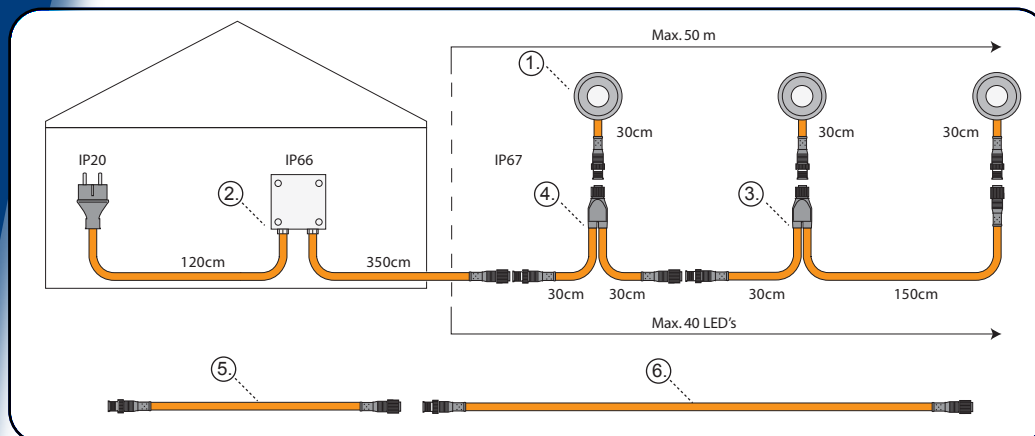

**CAUTION:** Always ensure the accessibility of cables and cable connections for potential interchangeability of components after the installation is completed. Do not install cables and connections directly in concrete, mortar or other adhesive bonding materials without using an accessible conduit system.